

# TGM2

## series

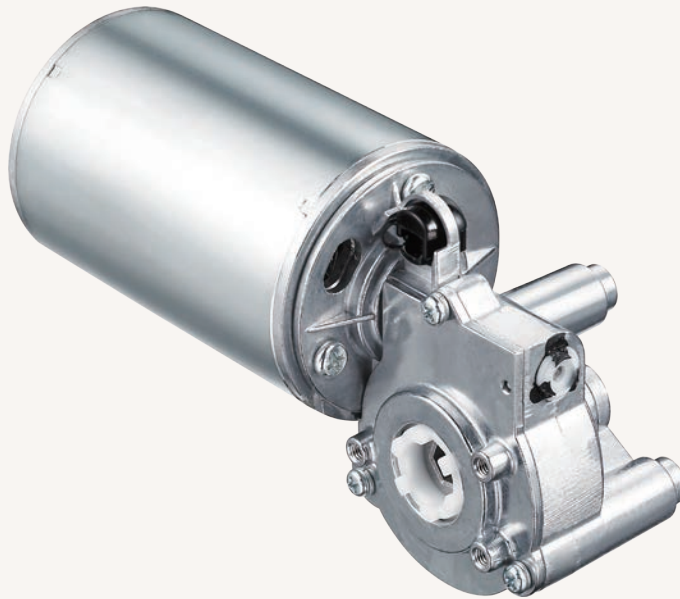

---

### Product Segments

- **Ergo Motion**

The TGM2 series gear motor is our most powerful gear motor. Although its primary use is for ergonomic applications like workplace adjustable height desks and tables, it can be used in a wide range of applications. This high torque product allows for quick, smooth and quiet adjustment of specially designed built-in spindles using external limit switches. Shafting allows mechanical synchronization of dual spindles.

#### General Features

Voltage of motor	24V DC
Maximum speed	107RPM ( $\pm 5\%$ ) after gear reduction
Torque	15.0Nm after gear reduction
Option	Hall sensor(s)
Hexogen hole for the shaft by 9mm diameter	
Low noise	

## Drawing

Standard Dimension  
(mm)

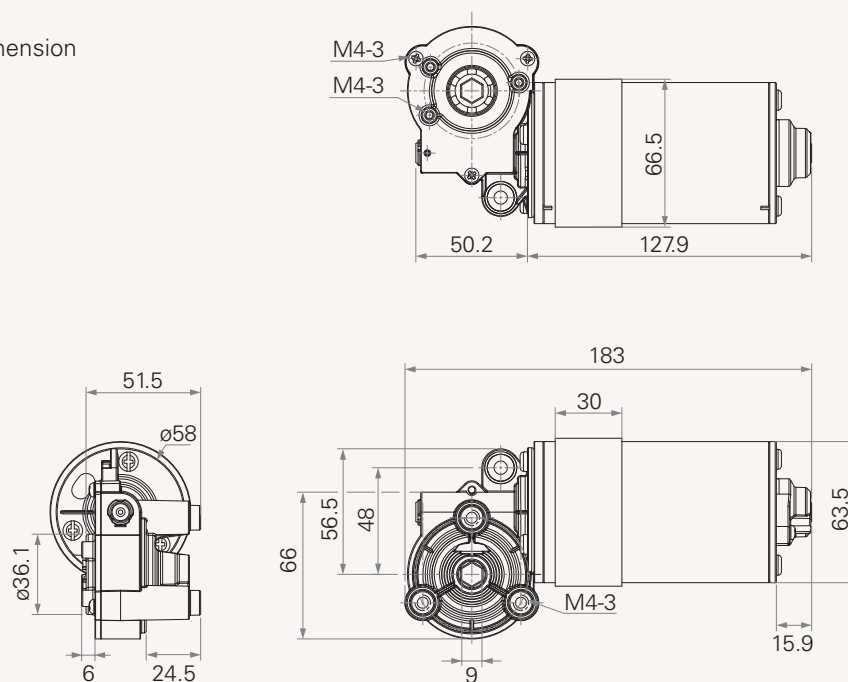

## Load and Speed

CODE	Rated Load		Typical Current at Rated Load (A)	Typical Speed	
	Torque (Nm)	Speed (RPM, ±5%)		32V DC (RPM, ±7%)	24V DC (RPM, ±5%)
Motor Speed (3800RPM)					
A	15.0	60	8.0	107	80
Motor Speed (2200RPM)					
B	11.0	34	3.5	60	45

## Terms of Use

The user is responsible for determining the suitability of TiMOTION products for a specific application.

Due to continuous development in order to improve our products, TiMOTION products are subject to frequent modifications and changes without prior notice.

TiMOTION reserves the right to discontinue the sale of any products displayed on its website or listed in its catalogue or other written materials drawn up by TiMOTION.

## Drawing

Shaft Selection1

Hexagon Hole (9mm)

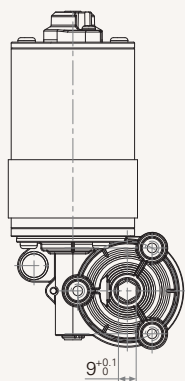

Shaft Selection2

Ø12, Knurling, One Side

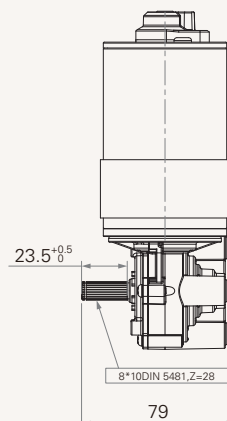

Shaft Selection3

Ø12, Knurling, Both Sides

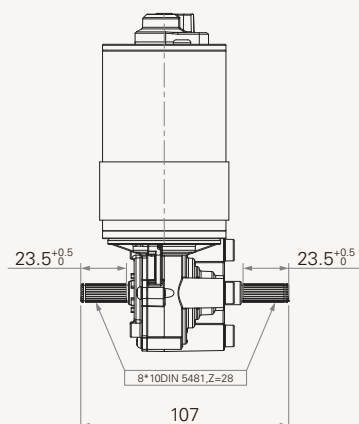

Shaft Selection4

Ø12, PIN

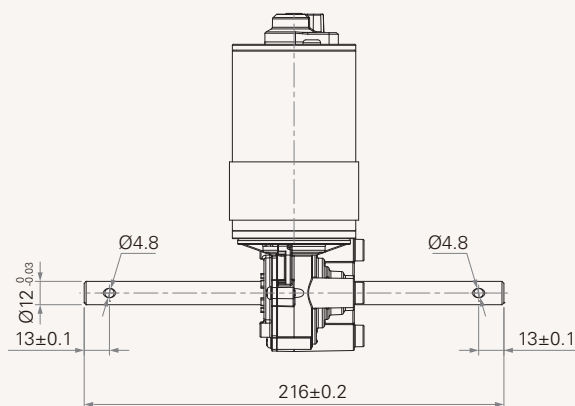

# TGM2 Ordering Key

## TGM2

Version: 20130509-D

<div></div>	<b>Voltage</b>	2 = 24V		
<div></div>	<b>Load and Speed</b>	See appendix		
<div></div>	<b>Output Signals</b>	0 = Without	1 = One Hall sensor	2 = Two Hall sensors
<div></div>	<b>Motor Brake</b>	0 = Without		1 = With
<div></div>	<b>Direction of Brake</b>	0 = Without	1 = Counterclockwise	2 = Clockwise
<div></div>	<b>Plug</b>	0 = Tinned leads	1 = TiMOTION's standard 6pin plug	2 = Molex plug 8PIN A = Customized
<div></div>	<b>Cable Length</b>	0 = Straight, 1000mm 1 = Straight, 1500mm	2 = Straight, 2000mm 3 = Coiled, 1000mm	A = Customized
<div></div>	<b>Shaft Selection (Refer to Illustration)</b>	1 = Hexagon hole (9mm) 2 = Ø12, knurling, one side		3 = Ø12, knurling, both sides 4 = Ø12, PIN
<div></div>	<b>External Limit Switch (TES2)</b>	0 = Without		1 = With
<div></div>	<b>Output Rotation (If with TES2)</b>	Number of hexagon rotations (up to 35 rotations); if without TES2, the code here will be 00		
<div></div>				